

Solids Flow Meter MULTISTREAM B

- Flow measurement based on the impact plate principle
- Compact design – no loss in installation height due to additional chutes
- Cost-effective, easy integration – offset-free alignment of inlet and outlet
- Dust-proof stainless steel housing
- Evaluation electronics can be integrated into the mechanics



Application

The MULTISTREAM B mass flow meter is a closed measuring system for continuous totalized amount of material and feed rate acquisition. With a conveying range of up to 100 t/h or a maximum of 80 m³/h, the measuring device is suitable for powdered to granular bulk materials with individual grain sizes up to 30 mm, and can be used for the following applications:

- Throughput and consumption measurement
- Balancing
- Batching

In combination with a controllable feeder, the MULTISTREAM B can also be used as a dosing system; however, this must be requested separately.

Thanks to the offset-free alignment of the inlet and outlet, the measuring device is particularly well suited for cost-effective integration into existing production systems.

Design

The basic scope of delivery for the MULTISTREAM B measuring device includes:

- Stainless steel housing
- Impact Plate
- Measuring device

The MULTISTREAM B is best complemented by an INTECONT Tersus evaluation unit, either locally in a VWG wall-mounted housing or by integrating the electronics into a control cabinet.

Function

This measuring device, which operates on the impact plate principle, determines the conveying rate by measuring a reactive force.

Guided by an inlet pipe, the bulk material stream strikes the impact plate, which is positioned at a defined angle. The sensor and the evaluation electronics detect the horizontal component of the reactive force.

Material build-up has no effect on the measurement result. This measuring device achieves optimal accuracy through reproducible feed conditions, such as drop height, impact angle, and fall velocity.

If higher accuracy is required, verification measurements are necessary to allow calibration of the measuring device without interrupting the bulk material feed." These additional components require weighing of the pre-silo and must be requested separately.

Dimension

MULTISTREAM B80 mass flow meter

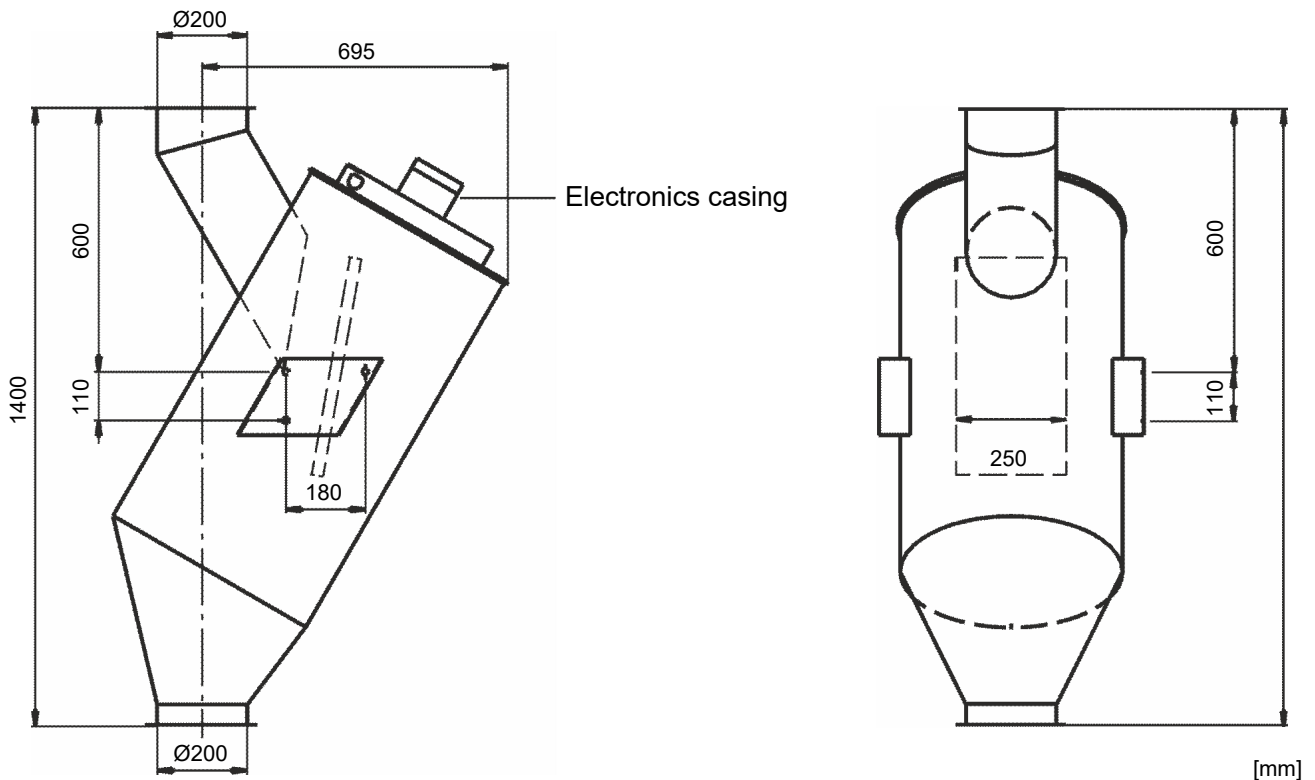

Top View

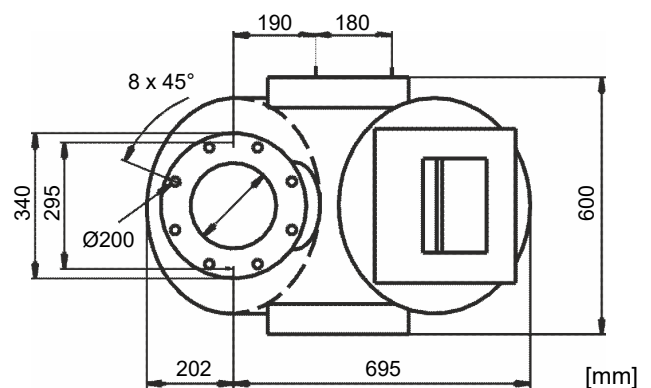

Technical Data

	MULTISTREAM B80 mass flow meter
Conveying rate	min. 1 t/h ... max. 80 m ³ /h (100 t/h)
Accuracy	±2 % of the nominal feedrate
Measurement area	1:5
Operating pressure	-25 mbar to 50 mbar
Flange dimensions (DIN) input / output	200 mm / 200 mm
Weight	50 kg
Ambient Temperature	-30 °C ... +60 °C
Bulk solids temperature	max. 70 °C
Material bulk density	min. 0.4 t/m ³
grain size	max. 10 mm (individual grains up to 30 mm)
Flow properties	non-adhesive, powder-like to granular

Accuracy

The accuracy stated refers to the max. feedrate (nominal feedrate) in each case in the range of 20 % ... 100 % of the nominal feedrate (measuring range 1:5) under the following conditions:

- Constant ambient conditions
- Assembly and commissioning corresponding to our assembly and commissioning instructions.

Additional requirements

If you also have specific requirements, please ask separately. Specific requirements could be:

- High accuracy
- Use as feed system

Order Data

Apart from the order numbers, in order to process your request quickly and smoothly we require the following order data:

Material data	
Bulk density [t/m ³]
Bulk solids
Feed rate range [t/h]	
from
to

